

Copyright © 2018 Leeds City Council. This drawing is the property of Leeds City Council. It must only be used for the purpose for which it was originally supplied. It must not be copied, published or transmitted by any means to any third party, without the express permission of the originator. Modification or manipulation of all or part of this drawing is strictly forbidden, unless specifically requested or approved by the originator.

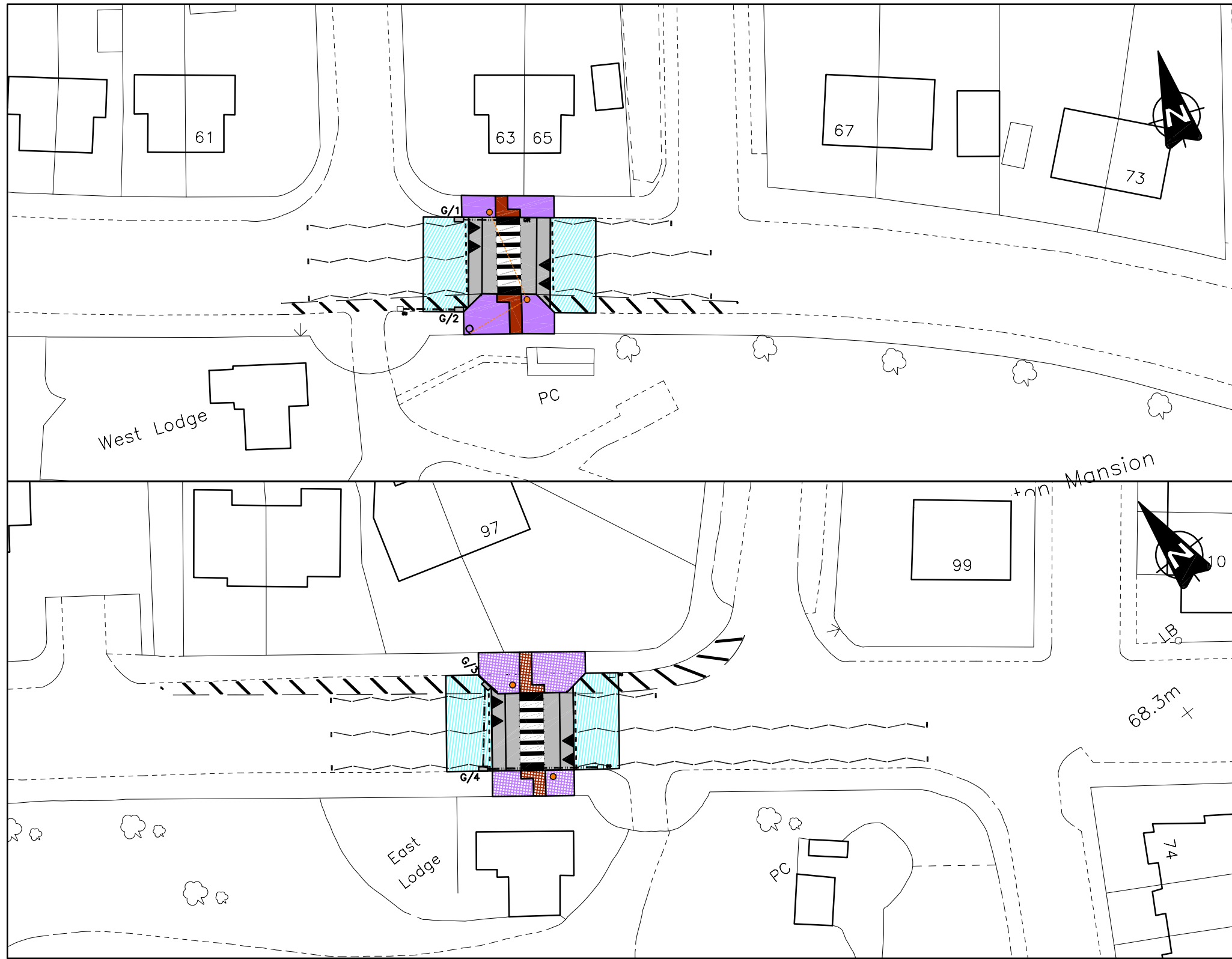

GENERAL ARRANGEMENT	
	New footway construction
	New carriageway construction
	New carriageway overlay
	New controlled crossing (red tactile paving)
	Existing footway construction
	Existing controlled crossing (red tactile paving)
	New Zebrite Belisha Beacon
	Upgrade Zebrite Belisha Beacon
1. This drawing is for information only. See relevant Contract Drawings for actual construction details and proposed works.	
Carriageway Gullies	
	GU Existing gully and frame to remain
	GR Existing gully and frame to be made redundant – clean out gully pot, rod connection and fill pot with concrete mix ST4. connection reused as indicated
	G/Ref. Proposed gully type 1 with connection type 150/D/1/A fitted with new cover and frame type D400 to BS EN124.
	Proposed 50mm Orange Ducting

© Crown Copyright and database right 2021 Ordnance Survey LA100019567

FIRST APPROVED	JFY		
AMENDMENTS	DRAWN	CHECK	DATE

**HAREHILLS LANE
(NEAR POTTERNEWTON PARK)
(W09) CHAPEL ALLERTON
GENERAL ARRANGEMENT DRAWING**

	INITIALS	DATE	SCALE
DRAWN BY	JFY	2/21	1:500
AutoCAD BY	JFY	2/21	
CHECKED BY			ORIGINAL SHEET SIZE A3



716/LCC/09/XX/DR/TM/01_01
INFORMATION

STATUS:	DRAFT
DATE:	February 2021